

SPECIFICATIONS

Current Rating: 3 AMP
 Insulation Resistance: 1000MΩ Min.
 Contact Resistance: 20mΩ Max.
 Dielectric Voltage: 500V AC for one minute
 Operation Temperature:-40°C to +105°C

ORDER INFORMATION

5 P S 1 M S A 4 5 - 2 X X X X N X N X U - 0 0

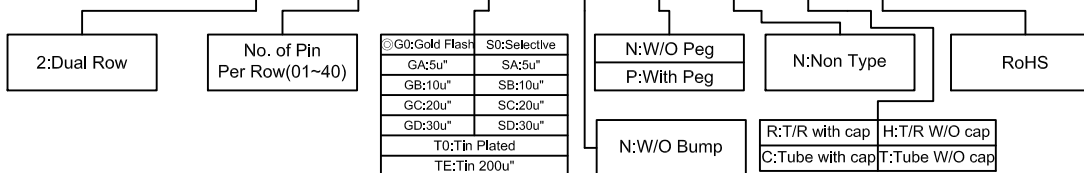

MATERIAL

Insulator: Hi-Temp. Thermoplastic, UL94V-0, Black
 Contact Pin: Copper Alloy

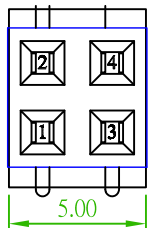

Special CAP for 2*2P-2*4P

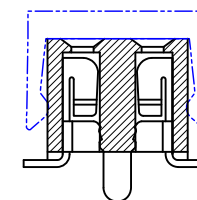
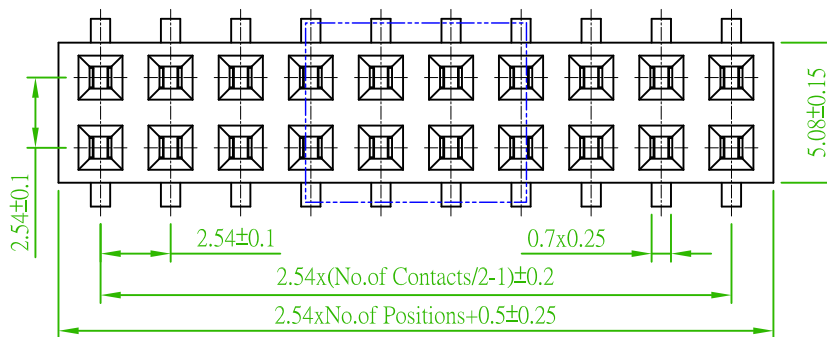

WITH POST

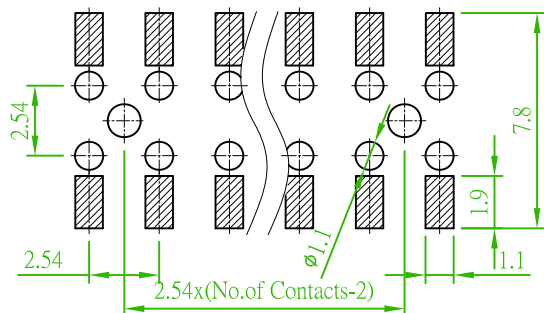

Recommended PCB Layout
 (PCB TOLERANCE ±0.1)

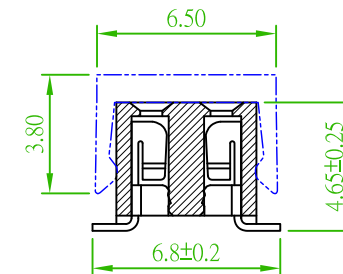
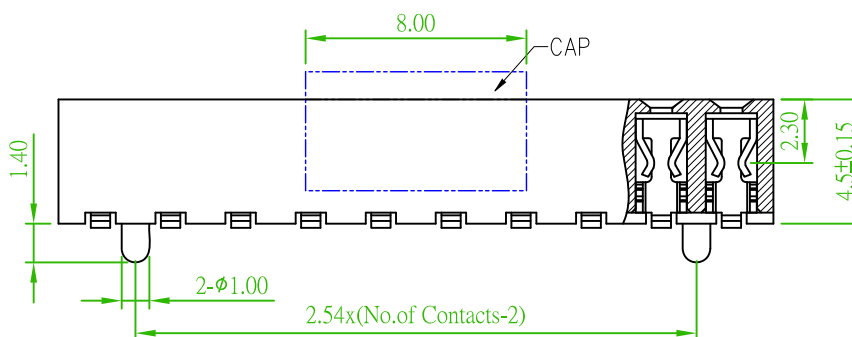

W/O POST

Old Part No. : PS1M45-2XX-U

REV.	Revised the Drawing	B	2016/11/15 Jeff
	ECN NO. OR DESCRIPTION	REVISED	DATE

TEL: 886-2-2260-6878
 FAX: 886-2-2260-8030

品名 TITLE	FEMALE HEADER 2.54mm D/R V/T SMT TYPE			頁數 Page	1/1
品號 PART NO.	5PS1MSA45-2XXXXNXNXU-00			繪圖 DRAWN	Athena 2015/08/31
圖號 DRAWING NO.	版本 REV.	B	核對 CHECKED	John 2015/08/31	
客戶品號 CUSTOMER P/N	比例 SCALE	None	承認 APPROVED	John 2015/08/31	
公差 TOLERANCE	.X ±0.40 .XX ±0.25	單位 UNIT	mm	THIRD ANGLE PROJECTION	